

NO.	DATE	REVISIONS
1		
2		
3		
4		
5		
6		
7		
8		
9		
10		
11		
12		
13		
14		
15		
16		
17		
18		
19		
20		

HAMILTON TOWNSHIP

SHEET 2  
M-1

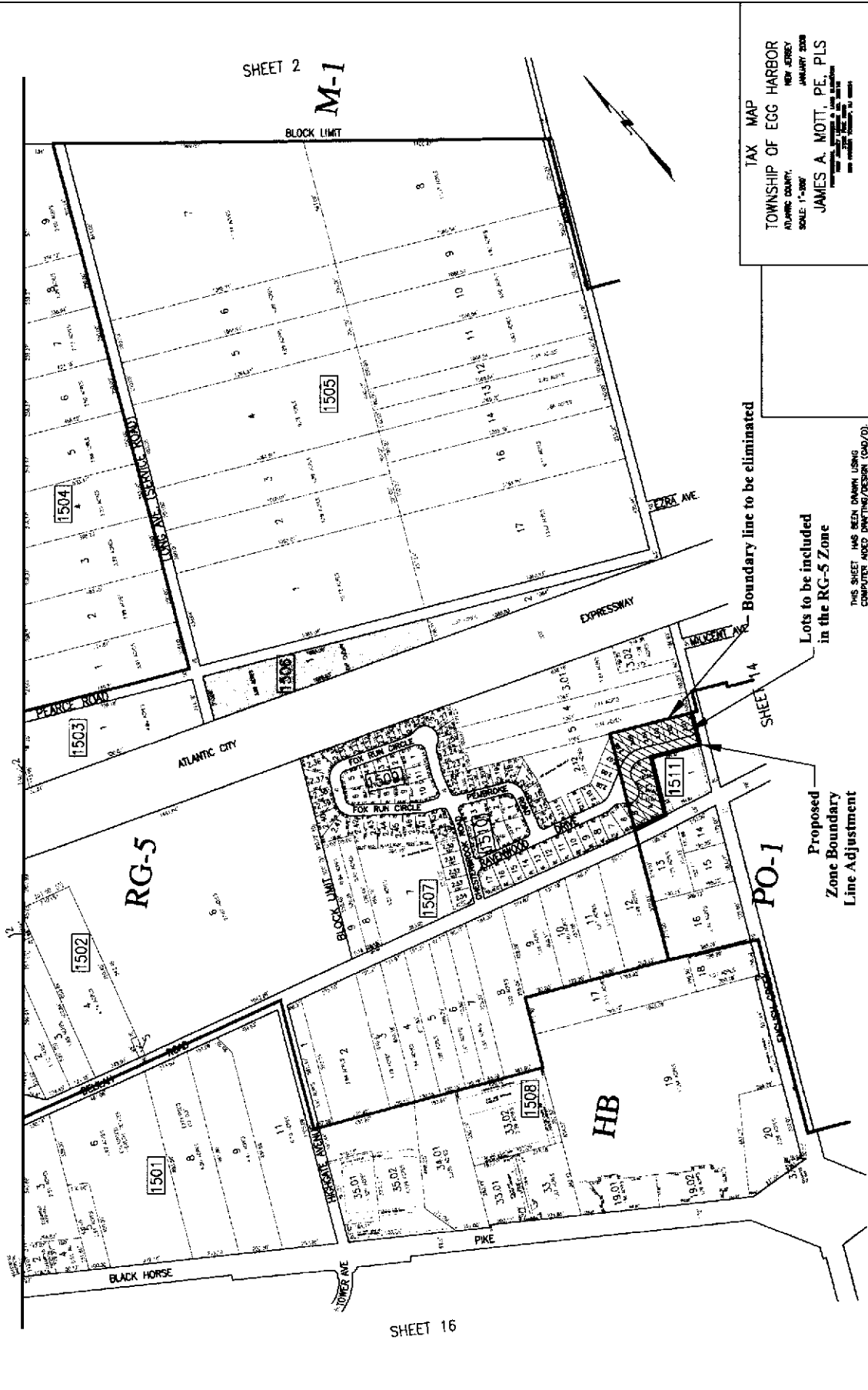

Boundary line to be eliminated

Lots to be included in the RG-5 Zone

Proposed Zone Boundary Line Adjustment

THIS SHEET HAS BEEN DRAWN USING COMPUTER AIDED DRAFTING (CAD) (2007/0)

TAX MAP  
TOWNSHIP OF EGG HARBOR  
ATLANTIC COUNTY, NEW JERSEY  
SCALE: 1"=200'  
JANUARY, 2008  
JAMES A. MOTT, P.E., PLS

SHEET 16